

# Room layout

Kyoto International Conference Center

**Room J**  
[Microreactors & microstructured systems, Fuel cells & electrochemical reaction engineering]

**Room I**  
[Modeling & simulation]  
(120 m<sup>2</sup>, 30-80 chairs each)

**Room K**  
[Resource conversion, Novel reactors & process development]

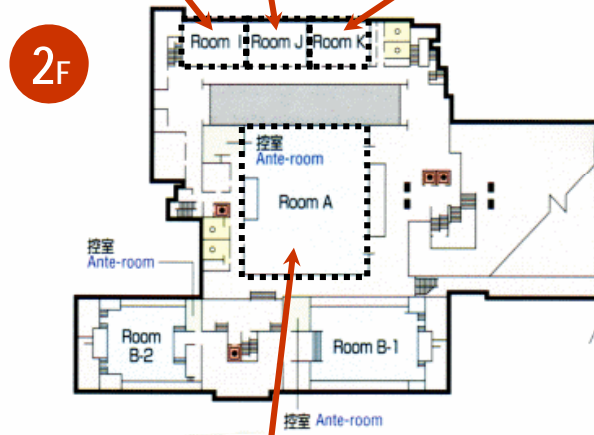
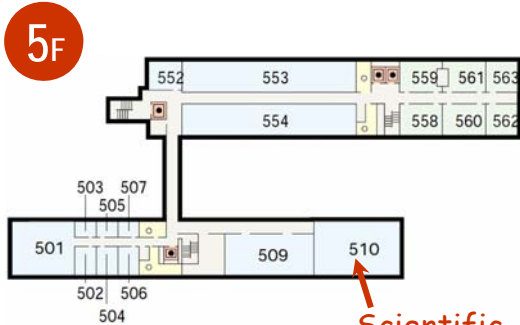

**Room A**  
[Plenary, Sustainable development, Energy & environment]  
(950 m<sup>2</sup>, 250-500 chairs)

Subway  
K01 Kokuzaikaikan exit

**Room H**  
[Catalysts & catalytic reaction engineering, Biochemical reaction engineering]

**Room G**  
[Materials processing, Fluidized bed & multiphase reactors]

ISCRE secretariat office

**Sakura**  
[Lunch & Conference dinner]

宝ヶ池プリンスホテル  
to Takaragaike Prince Hotel

Main entrance

Registration

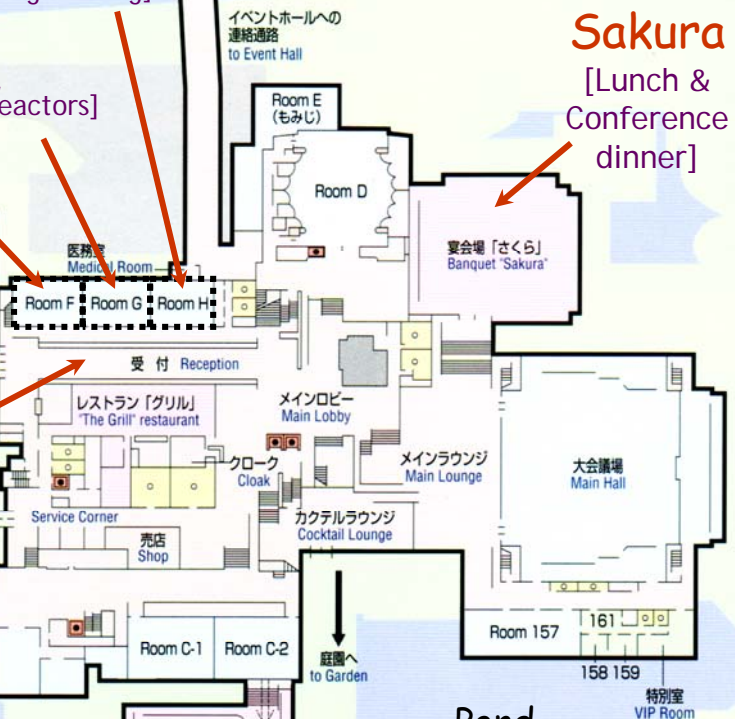

Pond

Garden

**Swan** [Reception & Poster session]

茶室「宝松庵」  
Tea Ceremony House 'Hoshooan'

1F