

Room layout

Kyoto International Conference Center

Room J
[Materials processing, Microreactors & microstructured systems, Fuel cells & electrochemical reaction engineering]

Room I
[Modeling & simulation]
(120 m², 30-80 chairs each)

Room K
[Resource conversion, Novel reactors & process development]

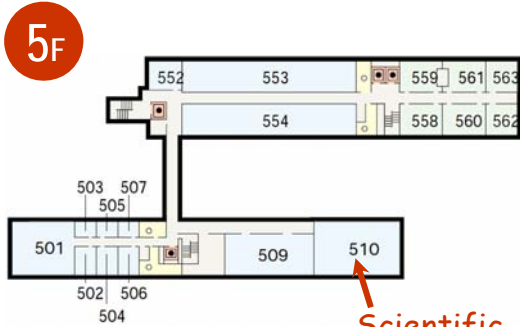

2F

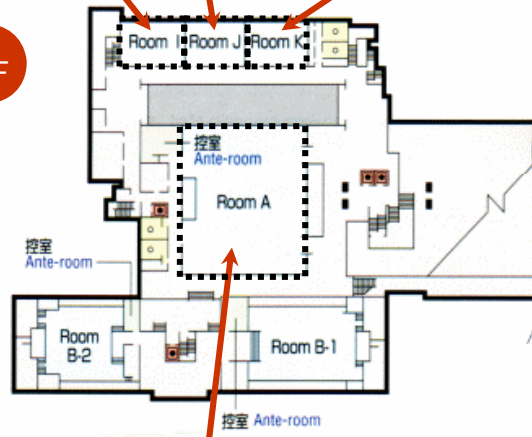

Room A
[Plenary, Sustainable development, Energy & environment]
(950 m², 250-500 chairs)

Subway
K01 Kokusaikaikan exit

Room H
[Materials processing, Catalysts & catalytic reaction engineering]

Room G
[Biochemical reaction engineering, Fluidized bed & multiphase reactors]

ISCRE secretariat office

Main entrance

Registration

Room F Room G Room H

イベントホールへの
連絡通路
to Event Hall

Sakura
[Lunch & Conference dinner]

宝ヶ池プリンスホテル
to Takaragaike Prince Hotel

医務室
Medical Room

受付 Reception

レストラン「グリル」
The Grill restaurant

メインロビー
Main Lobby

メインラウンジ
Main Lounge

クローク
Cloak

カクテルラウンジ
Cocktail Lounge

Service Corner

売店
Shop

大会議場
Main Hall

Room 157 161

158 159

特別室
VIP Room

庭園へ
to Garden

Pond

Garden

宴会場「スワン」
Banquet "Swan"

Swan [Reception & Poster session]

1F

